

Drawing Name: S:\MEADOW\MCA\dwg\MDOWPLAT.DWG By: roberts Tab: 11 x 17 1 LTScale: 500 DimScale: 500 PSLTScale: 0 8/18/2005

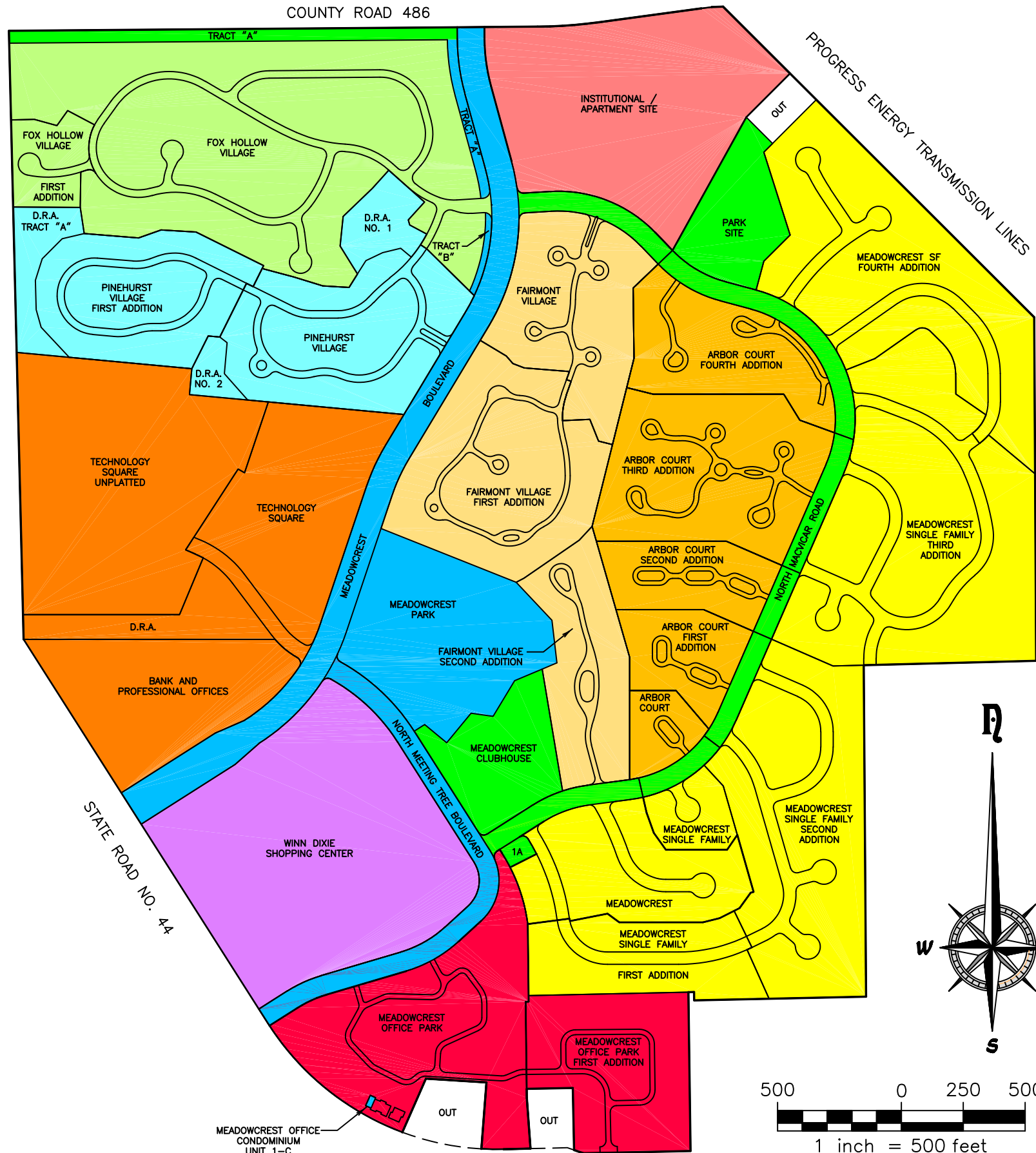

# MEADOWCREST COMMUNITY INDEX OF PROPERTY OWNER'S ASSOCIATIONS AND MISCELLANEOUS SITES

- 25.21 AC. ± = COMMUNITY COMMON AREA (NO CONDO)
- 18.88 AC. ± = COMMUNITY LIMITED COMMON AREA
  
- RESIDENTIAL
- 28.54 AC. ± = ARBOR COURT
- 28.29 AC. ± = FAIRMONT VILLAGE
- 33.60 AC. ± = FOX HOLLOW VILLAGE
- 71.48 AC. ± = HILLCREST SINGLE FAMILY
- 24.55 AC. ± = PINEHURST VILLAGE
  
- NON-RESIDENTIAL
- 17.30 AC. ± = ADVANTAGE (APARTMENT/INSTITUTIONAL) SITE
- 23.40 AC. ± = MEADOWCREST COMMERCIAL (WINN DIXIE) SITE
- 21.85 AC. ± = MEADOWCREST OFFICE PARK (INCLUDES CONDO)
- 41.78 AC. ± = TECHNOLOGY SQUARE

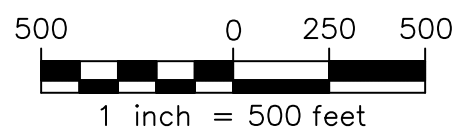
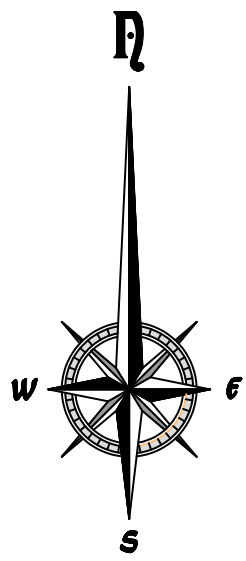

## SKETCH FOR MEADOWCREST COMMUNITY ASSOCIATION, INC.



Berryman & Henigar, Inc.  
1414 S.W. MARTIN LUTHER KING JR. AVE.  
OCALA, FLORIDA 34474-3129 (352) 368-5055  
(LB 6895)

SECTION 25, TOWNSHIP 18 SOUTH, RANGE 17 EAST, CITRUS COUNTY, FLORIDA		
DRAWN BY: RKR	DATE OF SKETCH: JUNE 3, 2005	SCALE: 1" = 500'
CHECKED BY: RKR	REVISIONS:	FIELD BOOK/ PAGE: N/A
COGO DISK/FILE: N/A		JOB NO.: 92143.00
DRAWING DISK/FILE: MDOWPLAT		FILE NO.: 3M-1328