

DESCRIPTION:

A PARCEL OF LAND LYING IN THE EAST 1/2 OF SECTION 25, TOWNSHIP 18 SOUTH RANGE 17 EAST, CITRUS COUNTY, FLORIDA, BEING MORE PARTICULARLY DESCRIBED AS FOLLOWS:

COMMENCING AT THE NORTHWEST CORNER OF TRACT 'A' OF PINEHURST VILLAGE FIRST ADDITION, AS RECORDED IN PLAT BOOK 15, PAGES 142-54 OF THE PUBLIC RECORDS OF CITRUS COUNTY, FLORIDA, THENCE N 92°20' W, ALONG THE EAST RIGHT-OF-WAY LINE OF SOUTH GULF STREET AS SHOWN ON THE PLAT OF MAYFAIR GARDEN ACRES, AS RECORDED IN PLAT BOOK 12, PAGES 144-42 OF THE PUBLIC RECORDS OF CITRUS COUNTY, FLORIDA, 352.30 FEET TO THE POINT OF BEGINNING, THENCE CONTINUE ALONG SAID RIGHT-OF-WAY LINE, N 02°20' W, 360.30 FEET TO AN INTERSECTION WITH THE SOUTH RIGHT-OF-WAY LINE OF COUNTY ROAD 486 100 FEET WIDE, THENCE N 89°30' E, ALONG SAID RIGHT-OF-WAY LINE, 80.05 FEET, TO AN INTERSECTION WITH THE WESTERLY RIGHT-OF-WAY LINE OF MEADOWCREST DRIVE AS SHOWN ON RECORDS BOOK 780, PAGE 402 OF THE PUBLIC RECORDS OF CITRUS COUNTY, FLORIDA; THENCE S 00°26' 38" E, ALONG SAID RIGHT-OF-WAY LINE, 47.80 FEET (S 02°26' 38" E, 47.80 FEET PER DESCRIPTION) TO THE POINT OF CURVATURE OF A CIRCULAR CURVE, CONCAVE EAST-ERLY AND HAVING A RADIUS OF 855.00 FEET; THENCE CONTINUE ALONG SAID WESTERLY RIGHT-OF-WAY LINE AND CURVE, SOUTHERLY, 22.35 FEET, THROUGH A CENTRAL ANGLE OF 19°50' 00" W, 55.78 FEET, TO THE NORTHERLY LINE OF PINEHURST VILLAGE, AS RECORDED IN PLAT BOOK 15, PAGES 142-54 OF THE PUBLIC RECORDS OF CITRUS COUNTY, FLORIDA; THENCE N 40°24' 30" W, ALONG SAID NORTHERLY LINE, 269.38 FEET (N 40°24' 30" W, 269.38 FEET PER PLAT); THENCE CONTINUE ALONG SAID NORTHERLY LINE, N 30°18' 00" W, 25.34 FEET (N 30°18' 00" W, 25.34 FEET PER PLAT); TO A NON-TANGENT INTERSECTION WITH A CIRCULAR CURVE, CONCAVE NORTH-WESTERLY AND HAVING A RADIUS OF 544.99 FEET; THENCE CONTINUE ALONG SAID NORTHERLY LINE AND CURVE, NORTH-EASTERLY, 50.00 FEET, THROUGH A CENTRAL ANGLE OF 02°19' 27" PER PLAT; AND A CHORD BEARING AND DISTANCE OF N 30°42' 28" E, 49.99 FEET (N 30°42' 28" E, 49.99 FEET PER PLAT); THENCE CONTINUE ALONG SAID NORTHERLY LINE, N 64°53' 13" W, 78.46 FEET (N 64°53' 13" W, 78.50 FEET PER PLAT); THENCE CONTINUE ALONG SAID NORTHERLY LINE, N 30°18' 00" W, 25.34 FEET (N 30°18' 00" W, 25.34 FEET PER PLAT); THENCE CONTINUE ALONG SAID NORTHERLY LINE, N 42°18' 45" E, 97.33 FEET (N 42°18' 45" E, 97.30 FEET PER PLAT); THENCE CONTINUE ALONG SAID NORTHERLY LINE, N 42°18' 45" E, 97.33 FEET (N 42°18' 45" E, 97.30 FEET PER PLAT); THENCE CONTINUE ALONG SAID NORTHERLY LINE, S 45°06' 00" W, 63.96 FEET (S 45°06' 00" W, 64.00 FEET PER PLAT); THENCE CONTINUE ALONG SAID NORTHERLY LINE, S 02°46' 24" W, 20.00 FEET (S 02°46' 24" W, 20.00 FEET PER PLAT); THENCE CONTINUE ALONG SAID NORTHERLY LINE, S 30°51' E, 153.08 FEET (S 30°48' E, 153 FEET PER PLAT); THENCE CONTINUE ALONG SAID NORTHERLY LINE, S 32°18' 30" W, 64.07 FEET (S 32°18' 30" W, 64.00 FEET PER PLAT); THENCE CONTINUE ALONG SAID NORTHERLY LINE, S 46°34' 15" W, 106.00 FEET (S 46°34' 15" W, 106 FEET PER PLAT); THENCE CONTINUE ALONG SAID NORTHERLY LINE, N 72°49' 15" W, 22.35 FEET (N 72°50' 15" W, 22 FEET PER PLAT); THENCE CONTINUE ALONG SAID NORTHERLY LINE, N 72°49' 15" W, 22.35 FEET (N 72°50' 15" W, 22 FEET PER PLAT); TO THE EASTERLY LINE OF AFOREMENTIONED TRACT 'A' OF PINEHURST VILLAGE FIRST ADDITION; THENCE N 28°24' E, ALONG SAID EASTERLY LINE, 12.30 FEET (N 28°27' 00" E, 12.00 FEET PER PLAT), TO AN INTERSECTION WITH THE SAD PINEHURST VILLAGE FIRST ADDITION; THENCE N 83°10' W, ALONG SAID NORTHERLY LINE, 304.79 FEET (N 83°33' 00" W, 304.80 FEET PER PLAT); THENCE CONTINUE ALONG SAID NORTHERLY LINE, N 86°26' 17" W, 44.52 FEET (N 86°30' W, 44.50 FEET PER PLAT); THENCE CONTINUE ALONG SAID NORTHERLY LINE, S 70°20' 00" W, 89.94 FEET (N 70°20' 00" W, 89.94 FEET PER PLAT); THENCE CONTINUE ALONG SAID NORTHERLY LINE, N 85°24' 47" W, 219.97 FEET (N 85°23' 15" W, 219.97 FEET PER PLAT); THENCE CONTINUE ALONG SAID NORTHERLY LINE, N 08°18' 15" W, 102.12 FEET (N 08°18' 15" W, 102.12 FEET PER PLAT); TO THE NORTH-EAST CORNER OF AFOREMENTIONED TRACT 'A' OF PINEHURST VILLAGE FIRST ADDITION; THENCE N 00°53' 26" E, 43.42 FEET; THENCE N 72°08' 05" E, 26.80 FEET, TO THE POINT OF CURVATURE OF A CIRCULAR CURVE, CONCAVE SOUTHERLY AND HAVING A RADIUS OF 30.00 FEET; THENCE EASTERLY, ALONG SAID CURVE, 43.34 FEET, THROUGH A CENTRAL ANGLE OF 77°08' 14" AND A CHORD BEARING AND DISTANCE OF S 69°17' 49" E, 37.41 FEET, TO A TANGENT INTERSECTION WITH A CIRCULAR CURVE, CONCAVE EASTERLY AND HAVING A RADIUS OF 200.00 FEET; THENCE NORTHERLY, ALONG SAID CURVE, 204.50 FEET, THROUGH A CENTRAL ANGLE OF 58°35' 10" AND A CHORD BEARING AND DISTANCE OF N 02°50' 17" W, 195.71 FEET; THENCE N 62°06' 32" W, 122.93 FEET; THENCE S 30°36' 45" W, 74.38 FEET; THENCE N 74°23' 35" E, 86.60 FEET; THENCE S 85°35' 55" W, 54.29 FEET TO THE POINT OF BEGINNING, CONTAINING 34.0 ACRES, MORE OR LESS.

FOX HOLLOW VILLAGE

A PORTION OF SECTION 25, TOWNSHIP 18 SOUTH, RANGE 17 EAST, CITRUS COUNTY, FLORIDA

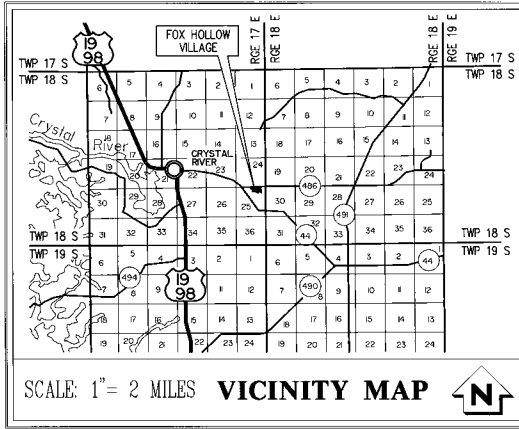

TOGETHER WITH A DRAINAGE AND UTILITIES EASEMENT ACROSS THE FOLLOWING DESCRIBED PARCEL: A PORTION OF DRAINAGE RETENTION AREA NO. 1 OF PINEHURST VILLAGE, AS RECORDED IN PLATBOOK 15, PAGES 148 - 150, OF THE PUBLIC RECORDS OF CITRUS COUNTY, FLORIDA, BEING MORE PARTICULARLY DESCRIBED AS FOLLOWS:

BEGINNING AT THE NORTHERNMOST CORNER OF SAID DRAINAGE RETENTION AREA NO. 1, THENCE S 48°24' 44" E (S 48°20' E PER PLAT), ALONG THE NORTHEASTLY LINE THEREOF, 89.00 FEET, TO A NON-TANGENT INTERSECTION WITH A CIRCULAR CURVE, CONCAVE NORTH-EASTERLY AND HAVING A RADIUS OF 375.00 FEET; THENCE NORTH-WEST-ERLY, ALONG SAID CURVE, 68.60 FEET, THROUGH A CENTRAL ANGLE OF 87°04' AND A CHORD BEARING AND DISTANCE OF N 54°50' 34" W, 86.60 FEET, TO THE POINT OF TANGENCY THEREOF; THENCE N 48°20' 44" W, PARALLEL WITH THE AFOREMENTIONED NORTH-EASTLY LINE OF DRAINAGE RETENTION AREA NO. 1, 103.04 FEET TO THE NORTHWEST-ERLY LINE OF SAID DRAINAGE RETENTION AREA; THENCE N 42°00' 00" E (N 42°03' E PER PLAT), ALONG SAID LINE, 13.00 FEET, TO THE POINT OF BEGINNING.

CONTAINING 0.037 ACRES, MORE OR LESS.

NOTES:

- 1. STORM WATER RUNOFF WILL BE RETAINED IN PRIVATE DRAINAGE RETENTION AREAS IN ACCORDANCE WITH THE APPROVED MEADOWCREST D.R.I. AND CITRUS COUNTY REGULATIONS.
2. ALL STREETS AND DRAINAGE RETENTION AREAS ARE TO BE DEDICATED TO AND MAINTAINED BY THE PROPERTY OWNERS ASSOCIATION ESTABLISHED FOR THIS SUBDIVISION.
3. THIS PROPERTY HAS A LAND USE DESIGNATION OF PDR - PLANNED DEVELOPMENT RESIDENTIAL - N IN ACCORDANCE WITH THE CITRUS COUNTY LAND DEVELOPMENT CODE.
4. ALL LOTS HAVE BEEN COMPUTED TO COMPLY WITH THE APPROVED MEADOWCREST D.R.I. AND WITH THE CITRUS COUNTY LAND DEVELOPMENT CODE, AS APPLICABLE, AND TO PROVIDE A MINIMUM SEPARATION OF 29 FEET FROM ANY STRUCTURE TO THE DESIGN HIGH WATER LINE OF THE DRAINAGE RETENTION AREAS.
5. THERE WILL BE NO AREAS OF OBVIOUS OR FREQUENT FLOODING EXCEPT DESIGNATED DRAINAGE RETENTION AREAS AND DRAINAGE EASEMENTS WITHIN THE PROPOSED SUBDIVISION.
6. THE WETLAND JURISDICTION LINE IN TRACT 'B' AS SHOWN HEREON WAS FIELD INSPECTED AND APPROVED ON TUESDAY MAY 2, 1995, BY BARRY BILLETTS OF THE SOUTHWEST FLORIDA WATER MANAGEMENT DISTRICT.
7. ACCORDING TO THE FLOOD INSURANCE RATE MAP (FIRM) DATED AUGUST 15, 1984, THE PROPERTY SHOWN HEREON APPEARS TO LIE IN ZONE 'C', AN AREA OF MINIMAL FLOODING, ACCORDING TO COMMUNITY PANEL NO. 100054-000-1, EXCEPT SOME PORTIONS OF TRACT 'B', WHICH APPEAR TO LIE IN ZONE 'A'.
8. THIS SUBDIVISION WILL BE SERVED BY THE CITRUS COUNTY PUBLIC WATER SYSTEM AND CITRUS COUNTY SEWER SYSTEM.
9. IN ACCORDANCE WITH THE DEDICATION LANGUAGE REFLECTED ON THE FACE OF THIS PLAT, TRACTS 'A', 'B', 'C', AND 'D' SHALL BE DEDICATED TO FOX HOLLOW VILLAGE PROPERTY OWNERS ASSOCIATION, INC. FOR THE PURPOSES OF GREENBELT, LANDSCAPING, UTILITIES, AND BUFFER ZONE.
10. IN ACCORDANCE WITH THE DEDICATION LANGUAGE REFLECTED ON THE FACE OF THIS PLAT, TRACTS 'D', 'E' AND 'F' SHALL BE DEDICATED TO FOX HOLLOW VILLAGE PROPERTY OWNERS ASSOCIATION, INC. FOR THE PURPOSES OF GREENBELT, LANDSCAPING, UTILITIES, AND BUFFER ZONE.
11. IN ACCORDANCE WITH THE DEDICATION LANGUAGE REFLECTED ON THE FACE OF THIS PLAT, TRACT 'H' SHALL BE DEDICATED TO PINEHURST VILLAGE PROPERTY OWNERS ASSOCIATION, INC. FOR THE PURPOSES OF GREENBELT, LANDSCAPING, UTILITIES AND BUFFER ZONE.
12. LANDSCAPING WITH AN EASEMENT FOR PINEHURST VILLAGE, DRAINAGE, UTILITIES, LANDSCAPE AND MAINTENANCE, RESERVED TO THE FOX HOLLOW VILLAGE PROPERTY OWNERS ASSOCIATION, INC.
13. CURVE RADI ON ALL BLOCK CORNERS ARE A MINIMUM OF 30 FEET.
14. BEARINGS ARE BASED ON THE RECORD PLAT OF PINEHURST VILLAGE, FIRST ADDITION, AS RECORDED IN PLATBOOK 15, PAGES 52 - 54, OF THE PUBLIC RECORD OF CITRUS COUNTY, FLORIDA, WITH THE NORTH LINE OF TRACT 'A' BEARING S 89°39'35" E.
15. AN EASEMENT FOR MAINTENANCE OF WATER AND SEWER FACILITIES SHALL BE CONVEYED TO CITRUS COUNTY BY A SEPARATE INSTRUMENT.
16. REFER TO SHEETS 2 AND 3 FOR DETAILED LOT LAYOUT AND SHEET 4 FOR ADDITIONAL DIMENSIONAL DATA TABLES.
17. ALL STREETS ARE PRIVATE AND WILL NOT BE ACCEPTED FOR MAINTENANCE BY THE BOARD OF COUNTY COMMISSIONERS OF CITRUS COUNTY, FLORIDA, NOR ARE THEY AVAILABLE FOR USE BY THE GENERAL PUBLIC.
18. THERE MAY BE ADDITIONAL RESTRICTIONS THAT ARE NOT RECORDED ON THIS PLAT THAT MAY BE FOUND IN THE PUBLIC RECORDS OF THIS COUNTY.
19. THAT PORTION OF THE PLATTED RIGHT-OF-WAY OF WEST LEXINGTON DRIVE, FROM PINEHURST VILLAGE PLATBOOK 13, PAGES 148 - 150) EXTENDING NORTHERLY TO THE INTERSECTION OF WEST CANNONDALE DRIVE, SHALL NOT BE CONSTRUCTED EXCEPT FOR INSTALLATION OF A SODDED, STABILIZED BASE AND SHALL BE FOR EMERGENCY USE ONLY.

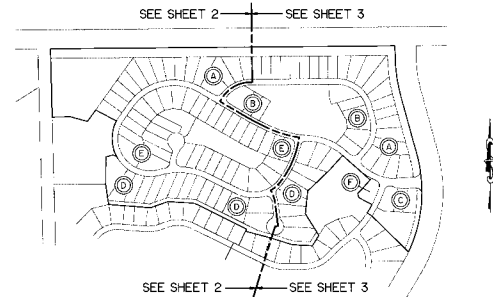

KEY MAP (NOT TO SCALE)

Legend table with symbols and descriptions:
- Square with dot: INDICATES PERMANENT REFERENCE MONUMENT SET 4" X 4" CONCRETE MONUMENT (P.R.M. 4834)
- Square with cross: INDICATES PERMANENT REFERENCE MONUMENT FOUND 4" X 4" CONCRETE MONUMENT (P.L.S. 2340)
- Square with circle: INDICATES PERMANENT REFERENCE MONUMENT FOUND 4" X 4" CONCRETE MONUMENT (P.L.S. 4008)
- Square with triangle: INDICATES PERMANENT REFERENCE MONUMENT FOUND 4" X 4" CONCRETE MONUMENT (NO. LB 808)
- Square with asterisk: INDICATES PERMANENT REFERENCE MONUMENT (NO. D) FOUND BASE OF BROKEN 4" X 4" CONCRETE MONUMENT
- Square with plus: INDICATES PROPOSED PERMANENT CONTROL POINT (TO BE SET WITHIN 1 YEAR OF THE RECORDS OF THIS PLAT)
- Circle with dot: P.C. INDICATES POINT OF CURVATURE
- Circle with cross: P.T. INDICATES POINT OF TANGENCY
- Circle with asterisk: P.C.C. INDICATES POINT OF COMPOUND CURVATURE
- Circle with plus: P.R.C. INDICATES POINT OF REVERSE CURVATURE
- Circle with dot: P.U. INDICATES PUBLIC UTILITIES
- Circle with dot: C & G L P.O.C. INDICATES CENTERLINE AND POINT OF COMMENCEMENT
- Circle with cross: P.O.B. INDICATES POINT OF BEGINNING
- Circle with asterisk: P.R.M. INDICATES PERMANENT REFERENCE MONUMENT
- Circle with plus: (M) INDICATES DIMENSION BASED ON PLAT
- Circle with dot: (D) INDICATES DIMENSION BASED ON DESCRIPTION
- Circle with asterisk: D.E. INDICATES DRAINAGE EASEMENT
- Circle with plus: D.R.A. INDICATES DRAINAGE RETENTION AREA
- Circle with dot: L.S. INDICATES REFERENCE TO A LINE DATA TABLE
- Circle with cross: C3 INDICATES REFERENCE TO A CURVE DATA TABLE
- Circle with asterisk: SEC. INDICATES SECTION
- Circle with plus: TWP. INDICATES TOWNSHIP
- Circle with dot: RW INDICATES RANGE
- Circle with asterisk: RGE. INDICATES RIGHT-OF-WAY
- Circle with plus: C.M. INDICATES CONCRETE MONUMENT
- Circle with dot: P.L.S. INDICATES PROFESSIONAL LAND SURVEYOR
- Circle with asterisk: P.S.M. INDICATES PROFESSIONAL SURVEYOR & MAPPER
- Circle with cross: (E) INDICATES BLOCK LETTER
- Circle with plus: (B) INDICATES REFERENCE TO BOUNDARY CURVE DATA TABLE

PREPARED BY:

Berryman & Henigar
BSI Consultants, Inc. - Henigar & Ray, Inc.
414 S.W. MARTIN LUTHER KING JR. AVE. PHONE (904) 368-5055
OCALA, FLORIDA 32474-3229 FAX (904) 368-5063

DEDICATION:

KNOW ALL MEN BY THESE PRESENTS, THAT MEADOWCREST DEVELOPMENT, INC. A FLORIDA CORPORATION BEING THE OWNER IN FEE SIMPLE OF THE LANDS IN THE ATTACHED PLAT ENTITLED FOX HOLLOW VILLAGE, LOCATED IN CITRUS COUNTY, FLORIDA, DOES HEREBY DEDICATE SAID LANDS AND PLAT FOR THE USES AND PURPOSES THEREIN EXPRESSED AND DEDICATES THE ROAD RIGHTS-OF-WAY, DRAINAGE EASEMENT AND TRACTS 'A', 'B', 'C', 'D', 'E', 'F', 'G', 'H', 'I', 'J', 'K', 'L', 'M', 'N', 'O', 'P', 'Q', 'R', 'S', 'T', 'U', 'V', 'W', 'X', 'Y', 'Z', TOGETHER WITH ALL IMPROVEMENTS THEREON, FOR THE USES AND PURPOSES NOTED HEREON, TO THE FOX HOLLOW VILLAGE PROPERTY OWNERS ASSOCIATION, INC., AND DOES HEREBY DEDICATE TRACT 'H' TOGETHER WITH ALL IMPROVEMENTS THEREON, FOR THE USES AND PURPOSES NOTED HEREON, TO THE PINEHURST VILLAGE PROPERTY OWNERS ASSOCIATION, INC., RESERVING UNTO THEMSELVES, THEIR SUCCESSORS OR ASSIGNS, THE REVERSION OR REVERSIONS THEREOF, WHENEVER DISCONTINUED BY LAW; AND THAT THE ROAD RIGHTS-OF-WAY AND EASEMENTS, AS SHOWN OR NOTED HEREON, ARE RESERVED AND GRANTED FOR THE INSTALLATION AND MAINTENANCE OF PUBLIC UTILITIES.

IN WITNESS WHEREOF, MEADOWCREST DEVELOPMENT, INC. HAS CAUSED THESE PRESENTS TO BE SIGNED AND ATTESTED TO BY THE OFFICERS NAMED BELOW AND ITS CORPORATE SEAL TO BE AFFIXED HERETO ON THIS 2nd DAY OF October, 1995.

ATTEST:

Signature of Stanley C. Olsen
STANLEY C. OLSEN, PRESIDENT
Signature of James W. Carman
JAMES W. CARMAN, SECRETARY - TREASURER

MEADOWCREST DEVELOPMENT, INC.
Signature of Stanley C. Olsen
STANLEY C. OLSEN, PRESIDENT
Signature of James W. Carman
JAMES W. CARMAN, SECRETARY - TREASURER

STATE OF FLORIDA COUNTY OF CITRUS

THE FOREGOING INSTRUMENT WAS ACKNOWLEDGED BEFORE ME THIS 2nd day of October, 1995, BY STANLEY C. OLSEN, AS PRESIDENT AND JAMES W. CARMAN, AS SECRETARY - TREASURER, OF MEADOWCREST DEVELOPMENT, INC., A FLORIDA CORPORATION, ON BEHALF OF SAID CORPORATIONS, THEY ARE PERSONALLY KNOWN TO ME OR HAVE PRODUCED AS IDENTIFICATION AND DID (DO NOT) TAKE AN OATH.

USA & FLORIDA
Notary Public
Florida Certificate Number CC 377417

ABSTRACTOR'S CERTIFICATE

I HEREBY CERTIFY THAT MEADOWCREST DEVELOPMENT, INC. IS THE RECORD OWNER OF THE LANDS HEREBY PLATTED, THAT THERE ARE NO DELINQUENT TAXES ON SUCH LANDS, THAT RECORD TITLE TO ALL ACCESS ROADS IS HELD BY CITRUS COUNTY OR THE STATE OF FLORIDA; AND THAT THERE ARE NO MORTGAGE HOLDERS OF RECORD CONCERNING THIS PROPERTY OTHER THAN AS SHOWN. DATED AT CITRUS COUNTY, FLORIDA, THIS 2nd DAY OF October, 1995.

SURVEYOR'S CERTIFICATE

I HEREBY CERTIFY THAT THIS PLAT OF FOX HOLLOW VILLAGE, IS A TRUE AND CORRECT REPRESENTATION OF THE LANDS AS RECENTLY SURVEYED AND PLATTED UNDER MY DIRECTION, THAT THE PERMANENT REFERENCE MONUMENTS AS SHOWN THEREON WERE IN PLACE ON THE EIGHTH DAY OF JUNE, 1995, AND THAT THIS PLAT COMPLIES WITH THE REQUIREMENTS OF CHAPTER 177, FLORIDA STATUTES.

ENGINEER'S CERTIFICATE

I, THE UNDERSIGNED PROFESSIONAL ENGINEER, HEREBY CERTIFY THAT THE ROAD AND DRAINAGE DESIGN AND CONSTRUCTION NECESSARY FOR THIS DEVELOPMENT ARE IN ACCORDANCE WITH THE CITRUS COUNTY SPECIFICATIONS AND GOOD ENGINEERING PRACTICES.

DATE: 10/2/95

APPROVAL OF OFFICIALS

Signature of County Engineer
Signature of Director of Public Works
Signature of Director of Environmental Health
Signature of Director of Planning

APPROVED AS TO FORM AND SUBSTANCE.

Signature of County Attorney
COUNTY ATTORNEY

COUNTY COMMISSIONERS APPROVAL

THE BOARD OF COUNTY COMMISSIONERS OF CITRUS COUNTY, FLORIDA, DOES HEREBY APPROVE THIS PLAT FOR RECORDING IN THE PUBLIC RECORDS AND ACCEPTS THE FOREGOING DEDICATION.
Signature of Vicki Phillips
VICKI PHILLIPS, CHAIRMAN OF THE BOARD

CLERK'S ACCEPTANCE

I HEREBY CERTIFY THAT THE ATTACHED PLAT CONFORMS WITH THE PROVISIONS OF CHAPTER 177, FLORIDA STATUTES, AND THAT SAID PLAT WAS FILED FOR RECORD IN PLAT BOOK 15, AT PAGES 142-151, OF THE PUBLIC RECORDS OF CITRUS COUNTY, FLORIDA, AT 11:04 A.M. ON NOVEMBER 2, 1995, FILE NO. 95-151.

PLAT BOOK 15, PAGE 148